



SSCSBAT54/A/C/SS6 Series

Schottky Barrier Diode

- **Features**

- ✧ Extremely fast switching speed
- ✧ Low forward voltage
- ✧ Very small conduction losses

- **PIN configuration**

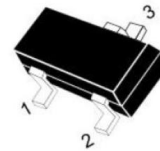

SOT-23

- **Applications**

- ✧ Ultra high-speed switching
- ✧ Voltage clamping
- ✧ Protection circuits
- ✧ Blocking diodes

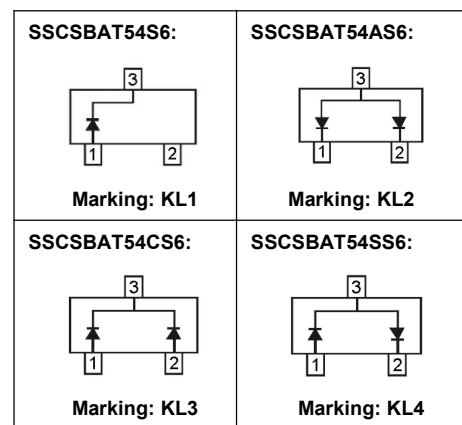

Circuit Diagram

- **Absolute maximum rating @T_A=25°C**

| Parameter | Symbol | Value | Unit |
|---|------------------|------------|------|
| Reverse Voltage (DC) | V _R | 30 | V |
| Average Rectified Forward Current | I _{FM} | 200 | mA |
| Non-repetitive Peak Forward Surge Current @ t=8.3ms | I _{FSM} | 600 | mA |
| Power Dissipation | P _D | 200 | mW |
| Thermal Resistance from Junction to Ambient | R _{θJA} | 500 | °C/W |
| Junction Temperature | T _J | 125 | °C |
| Storage Temperature | T _{STG} | -55 ~ +150 | °C |



● **Electrical Characteristics @T_A=25°C**

| Parameter | Symbol | Conditions | Min. | Typ. | Max. | Unit |
|-----------------------|-----------------|--|------|------|------|------|
| Reverse Voltage | V _R | I _R = 100uA | 30 | | | V |
| Forward Voltage | V _F | I _F = 0.1mA | | | 0.23 | V |
| | | I _F = 1mA | | | 0.30 | V |
| | | I _F = 10mA | | | 0.40 | V |
| | | I _F = 30mA | | | 0.50 | V |
| | | I _F = 100mA | | | 1.00 | V |
| Reverse Current | I _R | V _R = 25V | | | 2 | uA |
| Junction Capacitance | C _J | V _R =1V,f=1MHz | | | 10 | pF |
| Reverse recovery time | t _{rr} | I _F =I _R =10mA,R _L =100Ω,I _{RR} =0.1I _R | | | 5 | ns |

● **Typical Performance Characteristics**

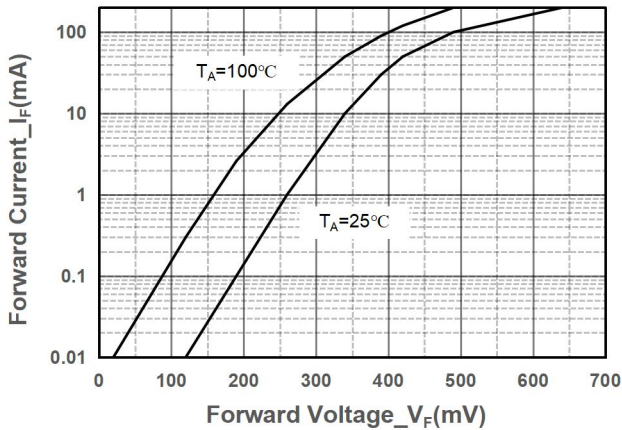

Forward Current vs. Forward Voltage

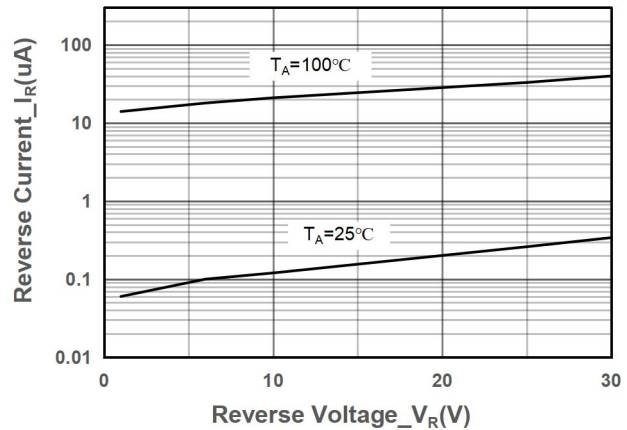

Reverse Current vs. Reverse Voltage

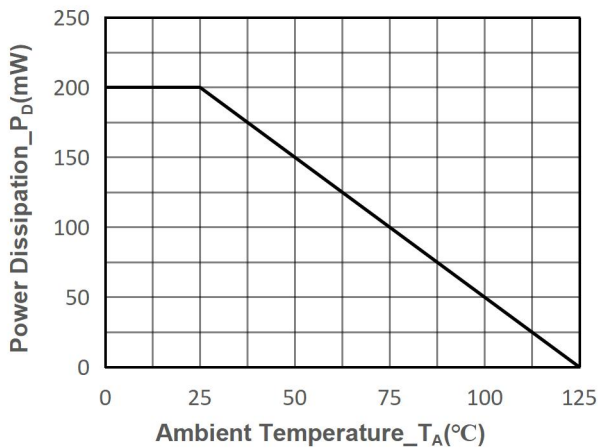

Power Derating vs. Ambient Temperature

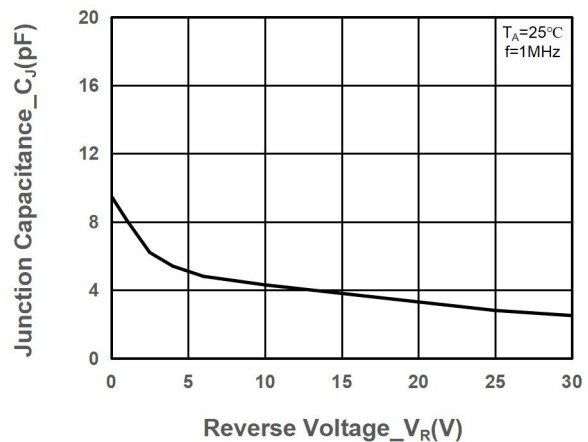

Junction Capacitance vs. Reverse Voltage



● Package Information

Ordering Information

| Device | Package | Marking | Qty per Reel | Reel Size |
|--------------|---------|---------|--------------|-----------|
| SSCSBAT54S6 | SOT-23 | KL1 | 3000 | 7 Inch |
| SSCSBAT54AS6 | SOT-23 | KL2 | 3000 | 7 Inch |
| SSCSBAT54CS6 | SOT-23 | KL3 | 3000 | 7 Inch |
| SSCSBAT54SS6 | SOT-23 | KL4 | 3000 | 7 Inch |

Mechanical Data

Case: SOT-23

Case Material: Molded Plastic. UL Flammability

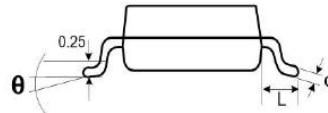
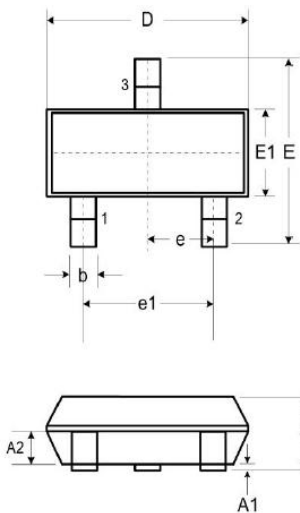

| DIM | Millimeters | | |
|-----|-------------|------|------|
| | Min. | Typ. | Max. |
| A | 0.89 | - | 1.12 |
| A1 | 0.01 | - | 0.10 |
| A2 | 0.88 | 0.95 | 1.02 |
| b | 0.30 | - | 0.51 |
| c | 0.08 | - | 0.18 |
| D | 2.80 | 2.90 | 3.04 |
| E | 2.10 | 2.37 | 2.64 |
| E1 | 1.20 | 1.30 | 1.40 |
| e1 | 1.90 | | |
| e | 0.95 | | |
| L | 0.40 | 0.50 | 0.60 |
| L1 | 0.55 | | |
| N | 3 | | |
| θ | 0° | - | 8° |

Recommended Pad outline (Unit: mm)

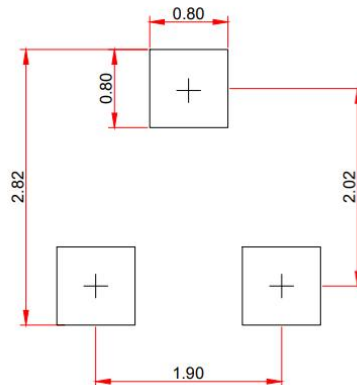



DISCLAIMER

AFSEMI RESERVES THE RIGHT TO MAKE CHANGES WITHOUT FURTHER NOTICE TO ANY PRODUCTS HEREIN TO IMPROVE RELIABILITY, FUNCTION OR DESIGN. AFSEMI DOES NOT ASSUME ANY LIABILITY ARISING OUT OF THE APPLICATION OR USE OF ANY PRODUCT OR CIRCUIT DESCRIBED HEREIN; NEITHER DOES IT CONVEY ANY LICENCE UNDER ITS PATENT RIGHTS, NOR THE RIGHTS OF OTHERS.

THE GRAPHS PROVIDED IN THIS DOCUMENT ARE STATISTICAL SUMMARIES BASED ON A LIMITED NUMBER OF SAMPLES AND ARE PROVIDED FOR INFORMATIONAL PURPOSE ONLY. THE PERFORMANCE CHARACTERISTICS LISTED IN THEM ARE NOT TESTED OR GUARANTEED. IN SOME GRAPHS, THE DATA PRESENTED MAY BE OUTSIDE THE SPECIFIED OPERATING RANGE (E.G. OUTSIDE SPECIFIED POWER SUPPLY RANGE) AND THEREFORE OUTSIDE THE WARRANTED RANGE.

OUR PRODUCT SPECIFICATIONS ARE ONLY VALID IF OBTAINED THROUGH THE COMPANY'S OFFICIAL WEBSITE, CRM SYSTEM, OR OUR SALES PERSONNEL CHANNELS. IF CHANGES OR SPECIAL VERSIONS ARE INVOLVED, THEY MUST BE STAMPED WITH A QUALITY SEAL AND MARKED WITH A SPECIAL VERSION NUMBER TO BE VALID.